



## NMO 3/4" Hole Mounts High Frequency Fully Shielded NMO Mount Standard Thickness Mounting

- Low loss up to 1.5 GHz • Zinc diecast enclosed mount • Solid brass NMO ring
- Teflon insulator with small gold contact pin

Model	Installed Connector	Coax Conductor	Description
1258	No-Conn.	Stranded	Mnt.w/17' RG-58
1258-24	No-Conn.	Stranded	Mnt.w/24' RG-58
1258-30	No-Conn.	Stranded	Mnt.w/30' RG-58
1258-UHF	UHF/PL-259	Stranded	Mnt.w/17' RG-58
1259	No-Conn.	Solid	Mnt.w/17' RG-58
1259-24	No-Conn.	Solid	Mnt.w/24' RG-58
1259-30	No-Conn.	Solid	Mnt.w/30' RG-58
1259-FME	FME	Solid	Mnt.w/17' RG-58
1259-MUHF	Mini-UHF	Solid	Mnt.w/17' RG-58
1259-SMA	SMA	Solid	Mnt.w/17' RG-58
<b>Not Installed Connectors</b>			
1258LCUHF	Crimp UHF	Stranded	Mnt.w/17' RG-58
1258LMUHF	Mini-UHF	Stranded	Mnt.w/17' RG-58
1259LCUHF	Crimp UHF	Solid	Mnt.w/17' RG-58
1259LMUHF	Mini-UHF	Solid	Mnt.w/17' RG-58

## NMO 3/4" Hole Mounts Standard Thickness Mounting

Solid Brass w/Gold Contact Pin - Teflon Insulator • 0-1000 MHz

Model	Installed Connector	Coax Conductor	Description
1250	UHF/PL259	Stranded	Mnt.w/17' RG-58
1251	No-Conn.	Stranded	Mnt.w/17' RG-58
1251-24	No-Conn.	Stranded	Mnt.w/24' RG-58
1251-30	No-Conn.	Stranded	Mnt.w/30' RG-58
1251-24-MUHF	Mini-UHF	Stranded	Mnt.w/24' RG-58
1252	No-Conn.	Solid	Mnt.w/17' RG-58
1252-24	No-Conn.	Solid	Mnt.w/24' RG-58
1252-30	No-Conn.	Solid	Mnt.w/30' RG-58
1252-BNC	BNC	Solid	Mnt.w/17' RG-58
1252-FME	FME	Solid	Mnt.w/17' RG-58
1252-MUHF	Mini-UHF	Solid	Mnt.w/17' RG-58
1252-SMA	SMA	Solid	Mnt.w/17' RG-58
1252-TNC	TNC	Solid	Mnt.w/17' RG-58
1252-N	N	Solid	Mnt.w/17' RG-58
1254	-	-	Mount Only
<b>Not Installed Connectors</b>			
1251LCUHF	Crimp UHF	Stranded	Mnt.w/17' RG-58
1251LMUHF	Mini-UHF	Stranded	Mnt.w/17' RG-58
1252LCUHF	Crimp UHF	Solid	Mnt.w/17' RG-58
1252LMUHF	Mini-UHF	Solid	Mnt.w/17' RG-58

## NMO 3/4" Hole Mounts • Fits 3/8" to 3/4" Hole

### Standard Thickness Mounting

Solid Brass w/Gold Contact Pin - Teflon Insulator • 0-1000 MHz

Model	Installed Connector	Coax Conductor	Description
2250	UHF/PL-259	Stranded	Mnt.w/17' RG-58
2251	No-Conn.	Stranded	Mnt.w/17' RG-58
2251-24	No-Conn.	Stranded	Mnt.w/24' RG-58
2251-30	No-Conn.	Stranded	Mnt.w/30' RG-58
2252	No-Conn.	Solid	Mnt.w/17' RG-58
2252-24	No-Conn.	Solid	Mnt.w/24' RG-58
2252-30	No Conn.	Solid	Mnt.w/30' RG-58
2252-MUHF	Mini-UHF	Solid	Mnt.w/17' RG-58
2252-N	N	Solid	Mnt.w/17' RG-58
2254	-	-	Mount Only

### UHF 5/8" Hole Mounts

Model	Installed Connector	Coax Conductor	Description
3251	UHF/PL-259	Stranded	Mnt.w/17' RG-58
3253	UHF/PL-259	Stranded	Mnt.w/17' RG-58

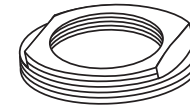
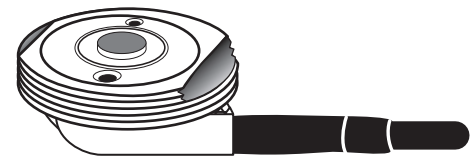

**1258  
1259  
Series**

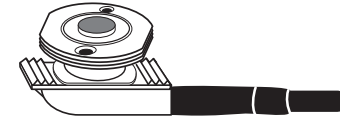

### 1250 Series

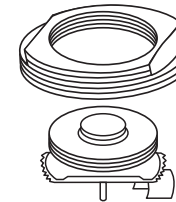
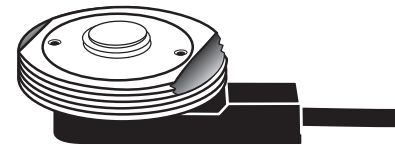

### 2250 Series

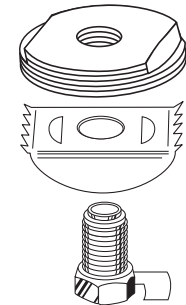
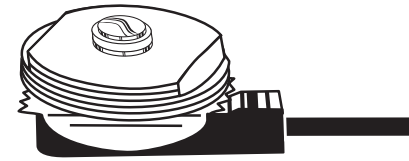

### 3251

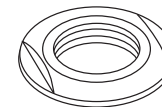
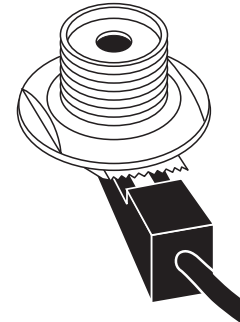

### 3253

